

# Harold Road LOT #1

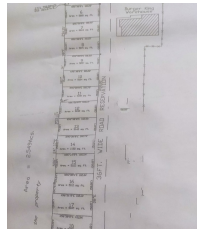

**Price:** \$500,000  
**Address:** HAROLD ROAD 1-ACRE LOT, Harold Road  
**City:** New Providence/Paradise Island  
**MLS#:** 56631  
**Lot Size:** 43,560 sq. ft.  
**Listing No:** R12  
**Beds:** 0  
**Baths:** 0  
**Living Area:** 43,560 sq. ft.  
**Year Built:** n/a  
**Status:** For Saleonly



## Property Details

Harold Road multi-family 1 acre property for sale! This prime acreage is nestled just southwest of the Burger King restaurant off the Tonique Williams-Darling/Harold Road highway and is ideal for a small private subdivision. This central location offers easy access to private and public schools, medical services, shopping, restaurants and beaches.

## Agent Details



 **Nassau/New Providence Office**

 [\*\*\(242\) 362-5219\*\*](tel:(242)362-5219)

 [\*\*\(242\) 362-5219\*\*](tel:(242)362-5219)



The Bahamas Real Estate Association is not responsible for the accuracy of the information listed above. The data relating to the real estate for sale or lease on this website comes in part from the Internet Data Exchange Program (IDX) and the Bahamas MLS, and is provided here for consumer's personal, non-commercial use. It may not be used for any purpose other than to identify prospective properties consumers may be interested in purchasing or leasing. Real Estate listings held in brokerage firms other than the office owning this website are marked with the IDX logo on the short inquiry. Data provided is deemed reliable but not guaranteed. This information is protected by copyright and all rights reserved. This property is shown courtesy of The Bahamas MLS.